

MAP REFERRED TO IN THE
COM

Highways England Company Limited (M58 Junction 1 Improvements) Compulsory Purchase Order 2018

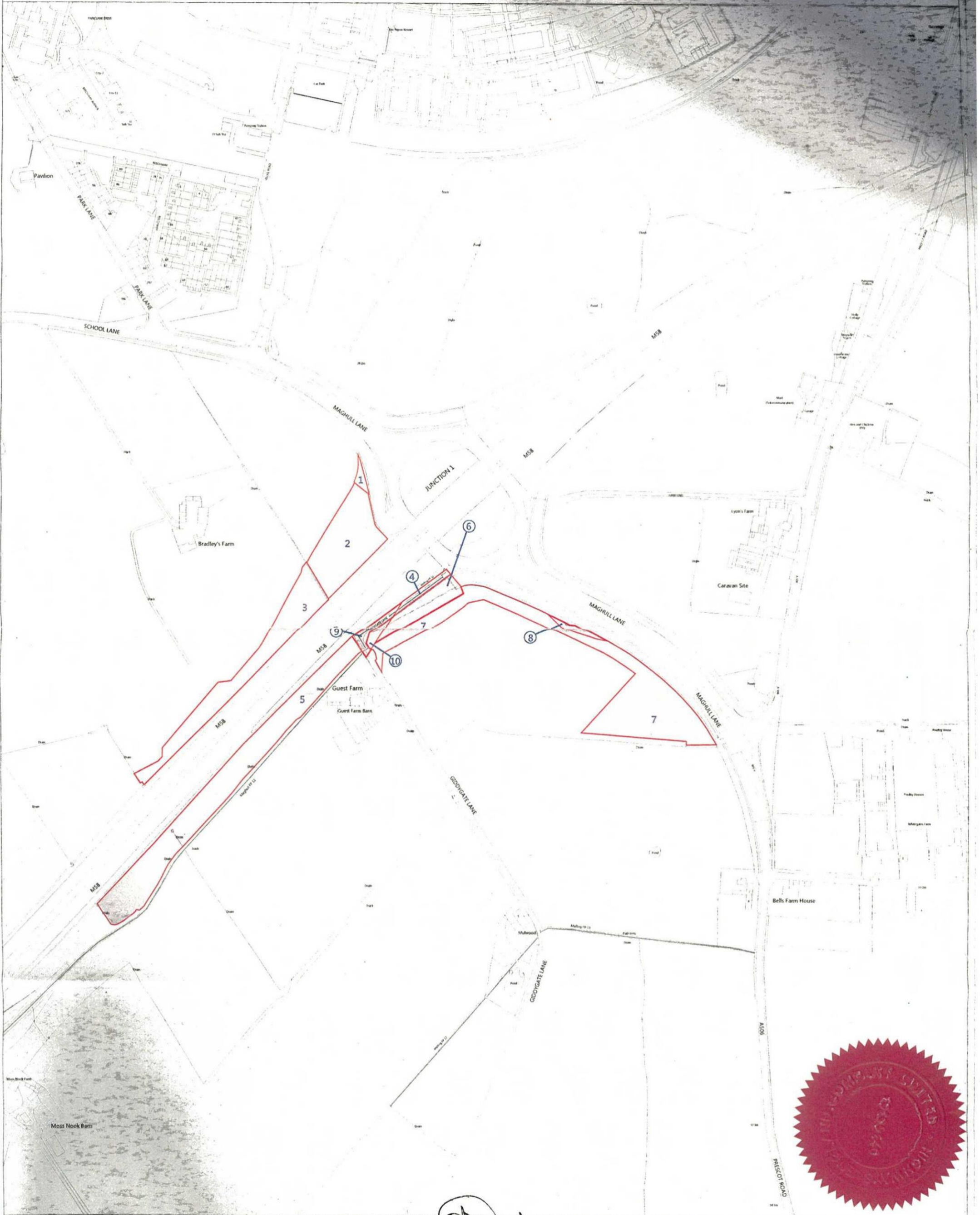

Dated: 09/01/2018 Version: 7.0



Scale 1:1250 when printed at A0

KEY

 Land to be Acquired

Where applicable the plot boundaries show the general boundary of the registered land. It does not show the exact line of the boundaries. Measurements scaled from this plan may not match measurements between the same points on the ground.

THE COMMON SEAL OF HIGHWAYS ENGLAND COMPANY LIMITED WAS HERETO AFFIXED IN THE PRESENCE OF:

(AUTHORISED SIGNATORY)

DATED THIS 2nd DAY OF February 2018

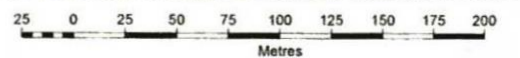

This map is based upon Ordnance Survey material with the permission of Ordnance Survey on behalf of the Controller of Her Majesty's Stationery Office © Crown copyright and database rights 2016 Ordnance Survey Licence Number 100018152. Unauthorised reproduction infringes crown copyright and may lead to prosecution or civil proceedings.

